

## ACT631 Tape & Reel Spec

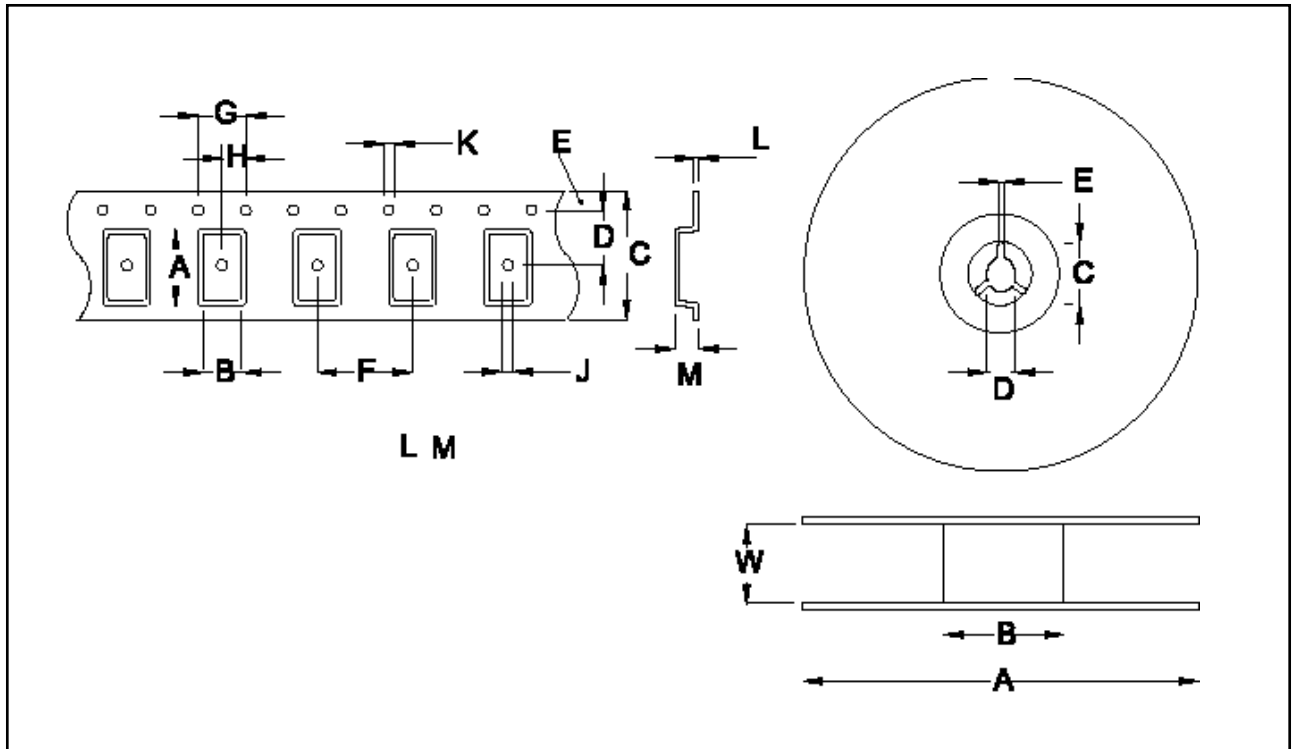

TAPE (mm)	
A	6.4 ±0.1
B	3.9 ±0.1
C	12.0 ±0.3
D	5.5 ±0.1
E	1.75 ±0.1
F	8.0 ±0.1
G	4.0 ±0.1
H	2.0 ±0.1
J	1.5 ±0.05 Dia
K	1.5 +0.1/-0 Dia
L	0.3 ±0.05
M	1.4 ±0.1

REEL (mm)	
A	178.0 ±1.0 Dia
B	80.0 ±1.0 Dia
C	21.0 ±0.8 Dia
D	13.0 ±0.5 Dia
E	2.5 ±0.5
W	12.4 +2.0/-0