

## Tape & Reel Spec for ACT ZTA & ZTT CC/CS/CV S/M Resonators

The ACT ZTA and ZTT families comprises a range of surface mount, ceramic resonators (chip type) in both two and three pad format. Three pad versions have built in capacitors. This family offers a cost effective solution to those applications where a wide temperature range, accuracy and surface mounting are the requirements.

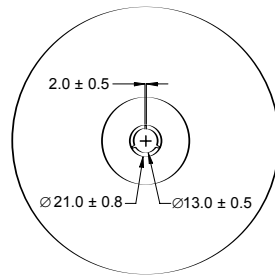

4000 TYP

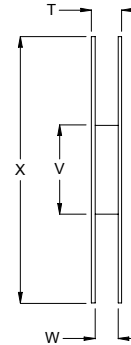

Reel Dimensions

∅X	∅V	W	T	Pieces Per Reel	Carrier Tape size
179 ± 2.0	60 typ	12.4	19.4	1000 typ	12
330 ± 3.0	80 min	16.4	22.4	4000 typ	16

Dimensions in mm

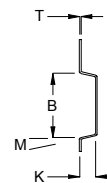
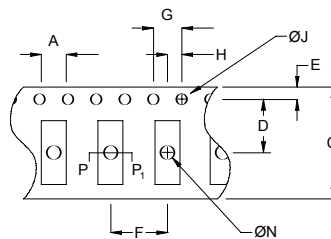

Tape Dimensions

Part No.	Code Tol.	A ±0.2	B ±0.2	C ±0.3	D ±0.1	E ±0.1	F ±0.1	G ±0.1	H ±0.1	∅J ±0.1	K ±0.2	M max	∅N ±0.1	R max
ZTACCxMG		3.8	7.8	16.0	7.5						2.1			
ZTTCCxMG														
ZTACSxMT/MX		5.0	4.4	12.0	5.5	1.75	8.0	4.0	2.0	1.5	1.8	10°	1.6	0.3
ZTTCSxMT/MX														
ZTACVxMT/MX		3.4	4.0	12.0	5.5						1.3			
ZTTCVxMT/MX														